

ITEM NO.	DESCRIPTION	QTY.
1	BODY	1
2	STEM	1
3	PACK WASHER	1
4	PACKING	1
5	PACK GLAND	1
6	SEAL CAP	1
7	FLARE SEAL CAP (OPTIONAL)	1

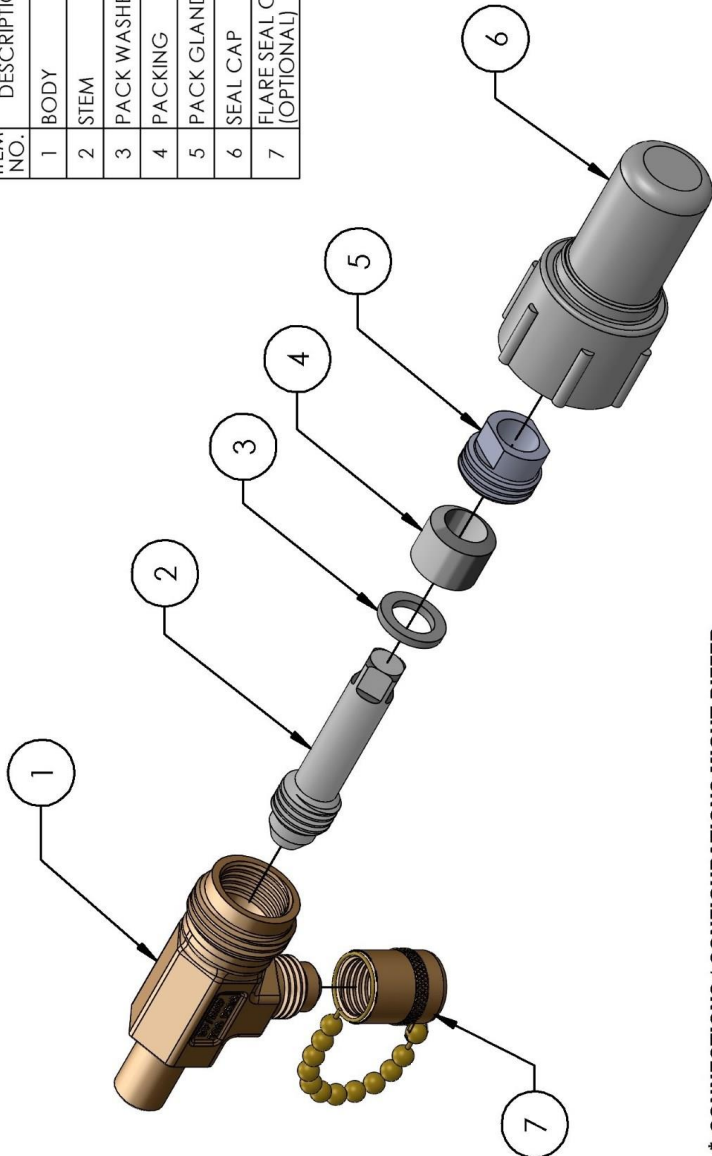

\* CONNECTIONS / CONFIGURATIONS MIGHT DIFFER.

### IMPORTANT:

- For your convenience, ODS valves are shipped from the factory with the stem and Seal cap(s) loosely assembled and the Packing components - Pack Gland, Packing and Pack Washer - separately packed in the bag.
- The exploded view shows the order of assembly of the components.
- Packing Gland torque: 8-12 ft.-lbs.(to Seal)
- Make sure to lubricate the Packing lightly with Refrigerant Oil.
- Please make sure to assemble the Packing Washer (3) before the Packing (4).
- Assembly Torque for Valve Core (**where applicable**): 1.5 - 3 lbf-in

DP/ MAP/ PS: **700 PSIG/ 48 BAR**

COT/ TS: **-40°F to 300°F/ -40°C to 149°C**

FOR USE WITH CFC, HFC, HCFC AND HFO REFRIGERANTS LISTED IN CAN/CSA B52 AND ANSI/ASHRAE 15 SEC. 9.2 WHERE THE SATURATION VAPOR PRESSURE AT 125°F (HIGH SIDE) AND 80°F (LOW SIDE) IS LESS THAN THE MAXIMUM DESIGN WORKING PRESSURE. AFTER CHARGING, MARK UNIT WITH REFRIGERANT TYPE AND OIL USED. NOT SUITABLE FOR USE WITH AMMONIA (R717).

PLEASE CONTACT FACTORY OR VISIT WEBSITE FOR SPECIFIC REFRIGERANT (AND OIL) RELATED APPLICATIONS.