

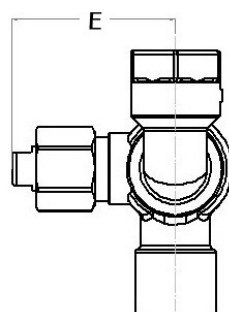

**Features:**

- Design Pressure (DP) / Maximum abnormal pressure (MAP): 1305 psig, 90 bar
- Continuous operating temperature (COT): -40°F/300°F, -40°C/149°C
- Contact factory or visit website for compatibility with CFC, HCFC, HFC and HFO refrigerants and oils
- Suitable for CO2 applications
- Allows easy replacement of attached relief valves and rupture discs while the system is operative.
- Offers solution for applications requiring a ball valve style pressure relief valve manifold
- Internally equalized ball design
- Rupture-proof encapsulated stem
- cULus listed by UL

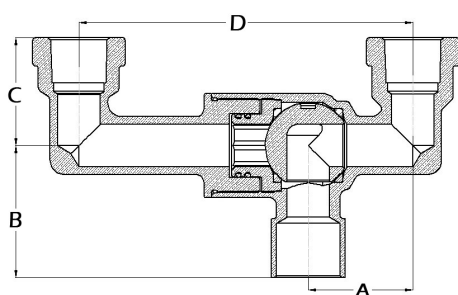

Part Number	Inlet x Outlet	A		B		C		D		E		Wt	
		in	mm	in	mm	in	mm	in	mm	in	mm	lb	kg
A 18730	7/8 ODS X 1/2 NPT	1.45	37	1.83	46	1.50	38	4.63	118	2.07	52	1.60	0.73
A 19043	1/2" NPTFE X 1/2" NPTFI	1.45	37	1.83	46	1.50	38	4.63	118	2.07	53	1.58	0.72