

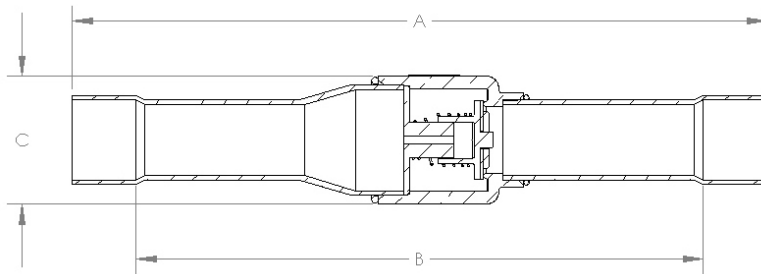

**Features:**

- Continuous operating temperature (COT): -40°F/300°F, -40°C/149°C
- Contact factory or visit website for compatibility with CFC, HCFC, HFC and HFO refrigerants and oils
- UL/cUL Recognized, Conforms to EU Pressure Equipment Directive and UK Pressure Equipment Regulation
- Enhanced internal design for maximum flow and minimum pressure drop
- Design Pressure (DP) / Maximum abnormal pressure (MAP): Charted Below



| Part Number | Size ODS |     | Cv   | Kv   | ΔP<br>psi | A    |      | B    |      | C    |      | Wt   |      | MAP  |      |    |
|-------------|----------|-----|------|------|-----------|------|------|------|------|------|------|------|------|------|------|----|
|             | in       | mm  |      |      |           | in   | mm   | in   | mm   | lb   | kg   | psig | bar  |      |      |    |
| A 18720     | 1/4      | 6   | 0.70 | 0.61 | 1         | 3.62 | 92   | 3.00 | 76   | 0.71 | 18   | 0.11 | 0.05 | 1305 | 90   |    |
| A 18721     | 3/8      | 10  | 1.40 | 1.21 | 1         | 4.29 | 109  | 3.60 | 91   | 0.71 | 18   | 0.12 | 0.05 | 1305 | 90   |    |
| A 18722     | 1/2      | 13  | 2.71 | 2.34 | .75       | 5.15 | 131  | 4.28 | 109  | 0.85 | 22   | 0.16 | 0.07 | 1305 | 90   |    |
| A 18723     | 5/8      | 17  | 4.10 | 3.55 | .75       | 5.43 | 138  | 4.43 | 113  | 1.00 | 25   | 0.22 | 0.10 | 1015 | 70   |    |
| A 18838     | 3/4      | 19  | 8.76 | 7.58 | .75       | 7.01 | 178  | 5.86 | 149  | 1.34 | 34   | 0.43 | 0.19 | 1015 | 70   |    |
| A 18724     | 7/8      | 22  | 9.19 | 7.95 | .75       | 6.50 | 165  | 5.25 | 133  | 1.34 | 34   | 0.42 | 0.19 | 1015 | 70   |    |
| AH18720     | *        | 1/4 | 6    | 0.70 | 0.61      | 4.4  | 3.62 | 92   | 3.00 | 76   | 0.71 | 18   | 0.12 | 0.05 | 1305 | 90 |
| AH18721     | *        | 3/8 | 10   | 1.40 | 1.21      | 4.4  | 4.29 | 109  | 3.60 | 91   | 0.71 | 18   | 0.12 | 0.05 | 1305 | 90 |
| AH18722     | *        | 1/2 | 13   | 2.71 | 2.34      | 4.4  | 5.15 | 131  | 4.28 | 109  | 0.85 | 22   | 0.17 | 0.07 | 1305 | 90 |
| AH18723     | *        | 5/8 | 17   | 4.10 | 3.55      | 4.4  | 5.43 | 138  | 4.43 | 113  | 1.00 | 25   | 0.29 | 0.13 | 1015 | 70 |
| AH18838     | *        | 3/4 | 19   | 8.76 | 7.58      | 4.4  | 7.01 | 178  | 5.86 | 149  | 1.34 | 34   | 0.43 | 0.19 | 1015 | 70 |
| AH18724     | *        | 7/8 | 22   | 9.19 | 7.95      | 4.4  | 6.50 | 165  | 5.25 | 133  | 1.34 | 34   | 0.43 | 0.19 | 1015 | 70 |

Prefixed AH for valve with 4.4 lb spring

Standard valve includes 1 lb spring

\* Prefixed AH for valves with higher ΔP

ΔP Minimum pressure at which valve fully opens.