

# M<sup>®</sup> Transducer Packed Line Valves INSTRUCTIONS

Valve installation and servicing should only be performed by qualified service technicians. Do not attempt to service while the valve is under system pressure

**HFC, HCFC, CFC, CO<sub>2</sub>**

Working Temp Range  
-40°C/149°C, -40°F/300°F

Max Working Pressure (PS)  
140 bar, 2031 psig

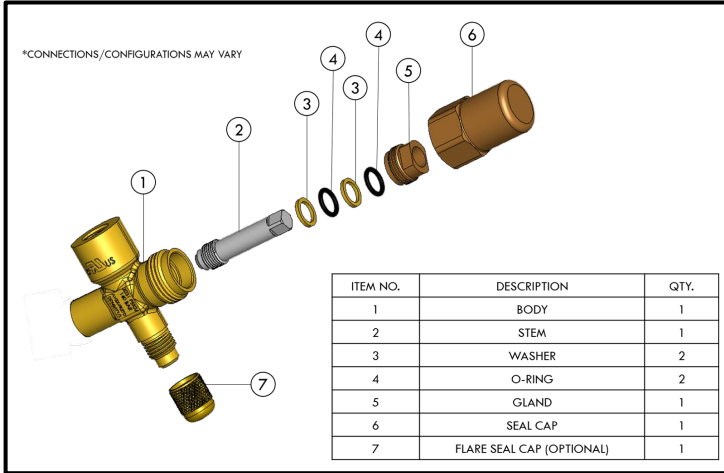
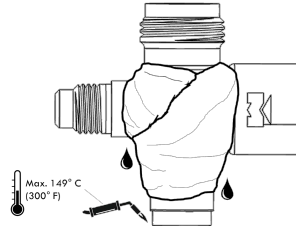

FORMS: INST-058  
5/8/25

# M<sup>®</sup> Transducer Packed Line Valves INSTRUCTIONS

## IMPORTANT:

- Valves with ODS/OD/FTG connections are shipped with Seal Cap(s) loosely assembled.
- To avoid heat damage, remove stem (including O-rings & washers if fully assembled) and valve core if installed in body before brazing.
- Ensure lubricated O-rings, washers, and stem remain free of debris.
- See exploded view for the proper reinstallation assembly method of internal components.
- Ensure proper installation of O-rings and washers into the body by slowly turning gland in a clockwise motion.
- Gland installation torque = 8 - 12 ft. lbs. (Item 5)
- Seal cap torque BRASS: 20-30 ft. lbs. (Item 6)
- 1/8" NPT torque = 96-144 inch/lbs.\*
- 1/4" NPT torque = 180-240 inch/lbs.\*
- Valve core torque (where applicable): 1.5-3 in. lbs.

\*Torque values are intended as a guide only. Type of metal, use, and type of sealant, thread quality, etc. will have a profound effect on torque.

**DP/MAP/PS: 2,031 psig / 140 Bar**  
**COT/TS: -40 °F to 300 °F / -40 °C to 149 °C**

FOR R744 (CO<sub>2</sub>) REFRIGERANT. PLEASE CONTACT MUELLER REFRIGERATION OR VISIT [muellerrefrigeration.com](http://muellerrefrigeration.com) FOR OTHER REFRIGERANT (AND OIL) RELATED APPLICATIONS.

CAUTION: NOT SUITABLE FOR USE WITH AMMONIA (R717).

FORMS: INST-058  
5/8/25

# M<sup>®</sup> Transducer Packed Line Valves INSTRUCTIONS

Valve installation and servicing should only be performed by qualified service technicians. Do not attempt to service while the valve is under system pressure

**HFC, HCFC, CFC, CO<sub>2</sub>**

Working Temp Range  
-40°C/149°C, -40°F/300°F

Max Working Pressure (PS)  
140 bar, 2031 psig

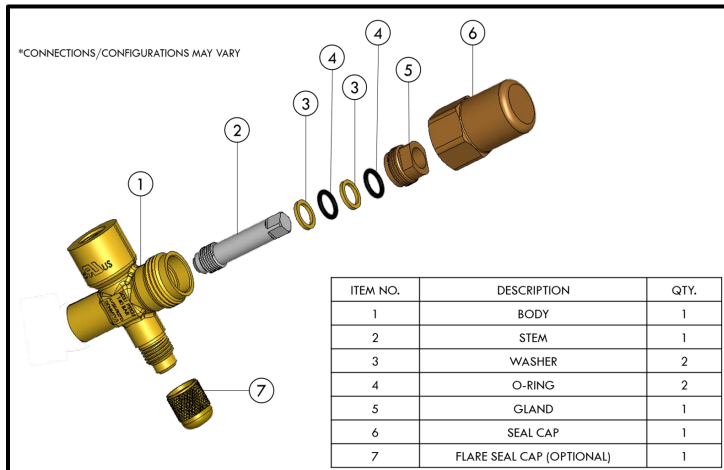
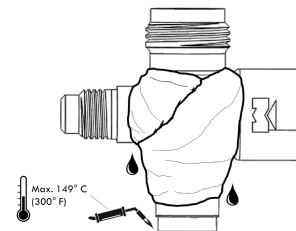

FORMS: INST-058  
5/8/25

# M<sup>®</sup> Transducer Packed Line Valves INSTRUCTIONS

## IMPORTANT:

- Valves with ODS/OD/FTG connections are shipped with Seal Cap(s) loosely assembled.
- To avoid heat damage, remove stem (including O-rings & washers if fully assembled) and valve core if installed in body before brazing.
- Ensure lubricated O-rings, washers, and stem remain free of debris.
- See exploded view for the proper reinstallation assembly method of internal components.
- Ensure proper installation of O-rings and washers into the body by slowly turning gland in a clockwise motion.
- Gland installation torque = 8 - 12 ft. lbs. (Item 5)
- Seal cap torque BRASS: 20-30 ft. lbs. (Item 6)
- 1/8" NPT torque = 96-144 inch/lbs.\*
- 1/4" NPT torque = 180-240 inch/lbs.\*
- Valve core torque (where applicable): 1.5-3 in. lbs.

\*Torque values are intended as a guide only. Type of metal, use, and type of sealant, thread quality, etc. will have a profound effect on torque.

**DP/MAP/PS: 2,031 psig / 140 Bar**  
**COT/TS: -40 °F to 300 °F / -40 °C to 149 °C**

FOR R744 (CO<sub>2</sub>) REFRIGERANT. PLEASE CONTACT MUELLER REFRIGERATION OR VISIT [muellerrefrigeration.com](http://muellerrefrigeration.com) FOR OTHER REFRIGERANT (AND OIL) RELATED APPLICATIONS.

CAUTION: NOT SUITABLE FOR USE WITH AMMONIA (R717).

FORMS: INST-058  
5/8/25