

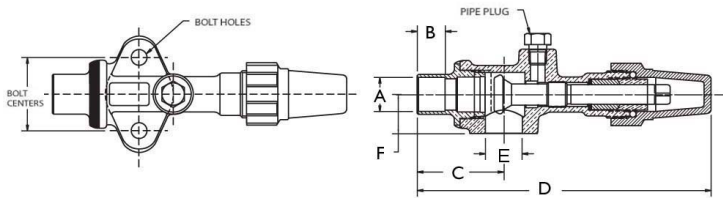

Features:

- Design Pressure (DP) / Maximum abnormal pressure (MAP): 700 psig, 48 bar
- Continuous operating temperature (COT): -40°F/300°F, -40°C/149°C
- Contact factory or visit website for compatibility with CFC, HCFC, HFC and HFO refrigerants and oils
- UL/cUL Recognized, Conforms to EU Pressure Equipment Directive and UK Pressure Equipment Regulation
- 100% tested
- Asbestos-free valve packing
- Valve openings designed for maximum flow and minimum pressure drop



Valve Part Number	Kit Part Number	A	B	C	D	E	F	Bolt Centers	Bolt Hole Diameter	Pipe Plug Size	Flange Thickness	Seat Position	Valve Wt	Kit Wt
		in mm	in mm	in mm	in mm	in mm	in mm	in mm	in mm	in	in mm		lb	kg
A 16310		3/4 19	0.62 16	1.91 49	6.49 165	0.81 21	0.88 22	1 5/8 41	.34 9	1/8	1 21/64 34	Front	1.64	
A 16311	A 17515	7/8 22	0.76 19	1.97 50	6.55 166	0.81 21	0.88 22	1 5/8 41	.34 9	1/8	1 21/64 34	Front	1.63	1.55 0.70
B 32197	A 17529	7/8 22	0.76 19	1.97 50	6.47 164	0.81 21	0.88 22	1 3/4 44	.34 9	1/8	1 21/64 34	Mid	1.42	1.69 0.77
A 15500		1 1/8 29	0.90 23	2.06 52	6.64 169	0.81 21	0.88 22	1 5/8 41	.34 9	1/8	1 21/64 34	Back	1.43	
A 16312	A 17516	1 1/8 29	0.90 23	2.06 52	6.64 169	0.81 21	0.88 22	1 5/8 41	.34 9	1/8	1 21/64 34	Front	1.66	1.55 0.70

Torque To Seal

Front Seat		Back Seat		Pack Gland		Pipe Plug	Plastic Cap	Brass Cap	Steel Cap
(ft-lb)	(N-m):	(ft-lb)	(N-m):	(ft-lb)	(N-m):			(ft-lb)	(N-m)
22 - 40	30 - 54	25 - 45	34 - 61	15 - 25	20 - 34	2 - 3 Threads Exposed	Hand Tight	40 - 50	54 - 68
									NA

References

Valve Part Number	Valve Kit *	Body Number	Standard Seal Cap			Replacement Seal Cap			Replacement Kit**	Manufacturer Reference	
			Material	Seal Cap *****	Kit	Plastic*****	Brass*****	Steel		Carrier	Copeland
A 16310		A 04707	Plastic	P 34632	P 35915	P 34632	A 15099	A 17419			
A 16311	A 17515	A 04707	Plastic	P 34632	P 35915	P 34632	A 15099	A 17419		998-0510-12	
B 32197	A 17529	A 04715	Plastic	P 34632	P 35915	P 34632	A 15099	A 17419	06DA660-062		
A 15500		A 04707	Plastic	P 34632	P 35915	P 34632	A 15099	A 17419			
A 16312	A 17516	A 04707	Plastic	P 34632	P 35915	P 34632	A 15099	A 17419		998-0510-13	

* Valve kit includes valve, gasket and bolts

** Replacement kit contains components to pack stem (pack gland, packing and pack washer)

*** Cap and cap gasket kit

**** Seal cap and o-ring kit

***** O-ring included