

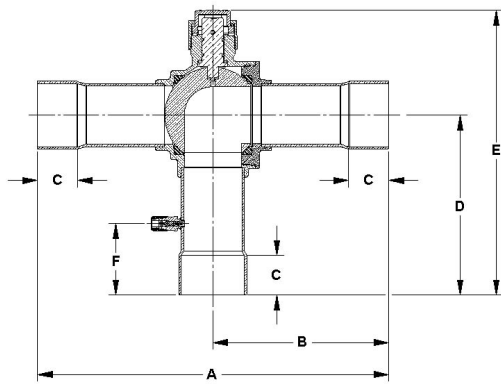

Features:

- Design Pressure (DP) / Maximum abnormal pressure (MAP): 2031 psi, 140 bar
- Continuous operating temperature (COT): -40°F/300°F, -40°C/149°C
- For R-744 with POE and PAG oil
- Brass body with copper-iron alloy connections
- Full port construction to match line size
- Rupture-proof, internally-loaded stem
- Specially selected o-ring material compatible for CO₂ operating conditions
- UL/cUL Listed, Conforms to EU Pressure Equipment Directive and UK Pressure Equipment Regulation

Transcritical CO₂, 140 bar 3-Way

Part Number	Size		Cv	Kv	A		B		C		D		E		F		Port (in)	Wt		Seal Cap Kit
	in	mm			in	mm	in	mm	in	mm	in	mm	in	mm	in	mm		lb	kg	
AU17860XHP	3/8	10	2.2	1.9	5.45	138	2.49	63	0.31	8	2.65	67	4.41	112	1.20	30	0.50	0.68	0.31	A 17842
AU17861XHP	1/2	13	3.9	3.4	5.73	146	2.63	67	0.38	10	2.79	71	4.55	116	1.34	34	0.50	0.68	0.31	A 17842
AU17862XHP	5/8	17	4.6	4.0	6.09	155	2.81	71	0.50	13	2.97	75	4.73	120	1.52	39	0.50	0.68	0.31	A 17842
AU17863XHP	3/4	19	11.9	10.3	5.83	148	2.76	70	0.62	16	2.84	72	5.04	128	1.18	30	0.75	1.54	0.70	A 17843
AU17864XHP	7/8	22	10.9	9.4	7.27	185	3.48	88	0.75	19	3.56	90	5.76	146	1.57	40	0.75	1.54	0.70	A 17843
AU17865XHP	1 1/8	29	19.3	16.7	7.27	185	3.51	89	0.91	23	3.47	88	5.88	149	1.57	40	1.00	3.01	1.36	A 17844