

**Date:** 8/10/2009  
**Subject:** Seal Cap Change Notification

Mueller Refrigeration is announcing a change for a plastic seal cap used on several types of valves. A small hole will be incorporated into the design to bleed off any pressure that may have accumulated inside the cap as the seal cap is removed. The hole is not a leak path and only bleeds off pressure as the cap is being removed.

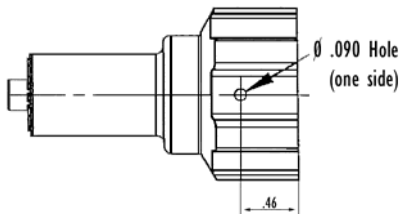

Part numbers that will now include the seal cap change are listed below:

PART	DESCRIPTION
A 13979	7/8C X 3/4MPT REC VALVE
A 15085	7/8in. O D C
A 15500	1-1/8 OD X 1-5/8 BC COMP
A 16310	3/4OD X 1 5/8BC COMP VALV
A 16311	7/8ODX1 5/8BC COMP VALV
A 16312	1 1/8ODX1 5/8BC 1/8P PL
A 16313	3/4OD COMP S O VALVE
A 16314	7/8OD COMP S O VALVE
A 16315	1 1/8 OD COMP VALVE
A 16316	1 3/8 OD COMP VALVE
A 16318	COMP VALVE SUB ASSEM
A 17515	2 BOLT COMP. VALVE
A 17516	2 BOLT COMP. VALVE
A 17525	2 BOLT BRASS COMP.
A 17526	2 BOLT BRASS COMP.
A 17527	2 BOLT BRASS COMP.
A 17528	SERVICE VALVE PACKAGE
A 17529	SERVICE VALVE PACKAGE
A 17530	SERVICE VALVE PACKAGE
A 17847	1 3/16 ORS X 1 1/16-12
A 17849	1 1/16-12UN-2AX13/16 ORS
A 17923	1 NPTF MANIFOLD ASSY
A 17924	1 1/4 NPTF MANIFOLD ASSY
B 10946	7/8OD COMP VALVE ASSEM
B 32080	7/8 BACKSEAT ANGLE VAL
B 32197	7/8OD PLUG COMP VALVE
B 33346	VALVE PACK
B 33350	VALVE PACK
B 33357	VALVE PACKAGE
B 33492	COMP. VALVE
B 33493	COMP. VALVE
B 33494	COMP. VALVE

PART	DESCRIPTION
B 33495	COMP. VALVE
B 33592	COMP SEALCAP&GASKET ASY
B 33647	1-1/8 OD COMP VALV
B 33650	7/8in. COMP. VALVE ASSEM
B 33743	REWORKED A-16316
B 33745	REWORKED A-16315
B 33785	1 1/8in. ODI C.V. W/METR
B 33786	7/8in. ODI C.V. W/METRIC
B 33790	COMP VLV ASS
B 33791	COMP VLV ASS
B 33839	3/4X1 5/8 COMP VLVE ASSY
B 33865	3/4 MPT X 3/4 FL END
B 34181	1 3/8 4 BOLT COMP VLV
B 34412	7/8 BAR STOCK VALVE ASSY
B 34416	1 1/8 BAR STOCK ROTOLOCK
B 34417	7/8 WIRELOCK VALVE ASSY
B 34479	1 1/8 BAR STOCK VALVE
B 34517	1 5/16 X 5/8 BAR STOCK
B 34521	1 3/8 4 BOLT BRASS VLV
B 34559	1 5/16 MANIFOLD VLV ASSY
B 34570	1 1/8 ANG. SO VALVE
B 34654	1 5/8 MANIFOLD ASSY
B 34667	1 1/8 2 BOLT COMP VALVE
B 34977	1 1/8 ODI 2 BLT COMP VLV
B 34978	3/4 ODI CWELDED BCV
B 35273	1 1/4 NPT MANIFOLD ASSY
B 35382	7/8 CV W/TUBE ASSY
B 35435	1 1/8 ROTOLOCK KIT
B 35444	5/8 ODS 2 BOLT CV ASSY
BY34559	1 5/16 MANIFOLD ASSEMBLY
BY34654	1 5/8 MANIFOLD ASSY

This change resulted in duplicate assembly numbers for the following list of valves. Only one part number will remain active. Replacement part numbers are indicated below:

PART	DESCRIPTION	REPLACEMENT PART
A 16317	7/8OD X 1-5/8BC COMP VAL	B 34552
B 33367	1 1/8in. COMP VALVE	B 34556
B 33613	7/8 COMP VALVE	B 34557
B 33926	3/4OD 1 5/8BC COMP VALV	B 35164
B 34839	7/8 2 BOLT COMP VALVE	B 32197

This change is currently in process and expected to be finalized by September 2009.

For further details, please contact your sales representative, or customer service at 800-251-8983.