

M[®] Rupture Disc Installation Instructions

WARNING

- Read these instructions carefully and completely before attempting to unpack, install or service the rupture disc assembly.
- These rupture disc assemblies are designed for refrigeration systems only, not for liquid service.
- Only knowledgeable, trained refrigeration technicians should install, operate, or service these rupture disc assemblies.
- Do not touch the internal rupture disc with tools, fingers, or any other item.
- The rupture disc will not burst at its design pressure if backpressure builds downstream of the disc.
- If unused, the 1/8" BOT side port must be plugged.
- Install the rupture disc assembly in such a way that equipment in the area will not prevent the rupture disc from opening or be damaged by system discharge.
- Piping should be braced to absorb shock when the disc ruptures.

INSTALLATION

When installing these rupture disc assemblies, ensure that the threads are clean. Seal threads with Teflon tape or pipe thread sealant. Be certain that nothing gets inside the rupture disc assembly.

Make sure that the rupture disc assembly is installed in the proper direction. The arrow stamped on the body of the rupture disc assembly should point in the direction of flow. This ensures that the disc will burst at its design pressure and ensures proper operation.

Make certain that the rupture disc assembly is installed tightly. One-half turn past hand tight is recommended.

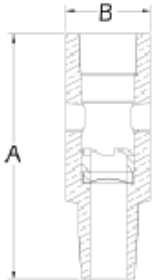

Configuration (inlet / outlet)	Size (NPT)	Type	Dimension	
			A	B
M/F	1/2" x 1/2"	ST	3.25" 83 mm	1 1/8" 29 mm

MAINTENANCE

The rupture disc assemblies properly installed required no maintenance, but should be visually inspected as part of the regular maintenance.

REPLACEMENT

There are no user-serviceable parts in the rupture disc assembly. The rupture disc assembly is a one-time-use item. If for any reason the rupture disc assembly is burst, it must be discarded and replaced with a new assembly.

Evacuate to zero pressure before removing rupture disc assembly from the system or otherwise opening the system.

M[®] Rupture Disc Installation Instructions

WARNING

- Read these instructions carefully and completely before attempting to unpack, install or service the rupture disc assembly.
- These rupture disc assemblies are designed for refrigeration systems only, not for liquid service.
- Only knowledgeable, trained refrigeration technicians should install, operate, or service these rupture disc assemblies.
- Do not touch the internal rupture disc with tools, fingers, or any other item.
- The rupture disc will not burst at its design pressure if backpressure builds downstream of the disc.
- If unused, the 1/8" BOT side port must be plugged.
- Install the rupture disc assembly in such a way that equipment in the area will not prevent the rupture disc from opening or be damaged by system discharge.
- Piping should be braced to absorb shock when the disc ruptures.

INSTALLATION

When installing these rupture disc assemblies, ensure that the threads are clean. Seal threads with Teflon tape or pipe thread sealant. Be certain that nothing gets inside the rupture disc assembly.

Make sure that the rupture disc assembly is installed in the proper direction. The arrow stamped on the body of the rupture disc assembly should point in the direction of flow. This ensures that the disc will burst at its design pressure and ensures proper operation.

Make certain that the rupture disc assembly is installed tightly. One-half turn past hand tight is recommended.

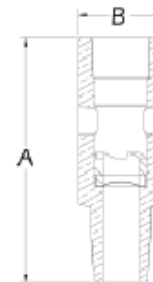

Configuration (inlet / outlet)	Size (NPT)	Type	Dimension	
			A	B
M/F	1/2" x 1/2"	ST	3.25" 83 mm	1 1/8" 29 mm

MAINTENANCE

The rupture disc assemblies properly installed required no maintenance, but should be visually inspected as part of the regular maintenance.

REPLACEMENT

There are no user-serviceable parts in the rupture disc assembly. The rupture disc assembly is a one-time-use item. If for any reason the rupture disc assembly is burst, it must be discarded and replaced with a new assembly.

Evacuate to zero pressure before removing rupture disc assembly from the system or otherwise opening the system.