

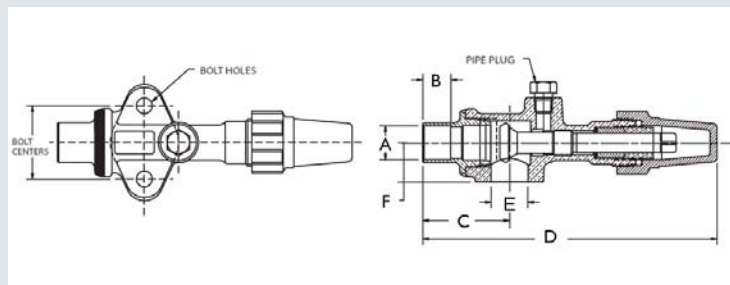

Features:

- Design Pressure (DP) / Maximum abnormal pressure (MAP): 700 psig, 48 bar
- Continuous operating temperature (COT): -40°F/300°F, -40°C/149°C
- Contact factory or visit website for compatibility with CFC, HCFC, HFC and HFO refrigerants and oils
- UL/cUL Recognized, Conforms to Pressure Equipment Directive 2014/68/EU
- 100% tested
- Asbestos-free valve packing
- Valve openings designed for maximum flow and minimum pressure drop



Valve Part Number	Kit Part Number	A	B	C	D	E	F	Bolt Centers	Bolt Hole Diameter	Pipe Plug Size	Flange Thickness	Seat Position	Valve Wt	Kit Wt											
		in	mm	in	mm	in	mm	in	mm	in	mm		lb	kg											
A 16310		3/4	19	0.62	16	1.91	49	6.49	165	0.81	21	0.88	22	1 5/8	41	.34	9	1/8	1 21/64	34	Front	1.64	0.74		
A 16311	A 17515	7/8	22	0.76	19	1.97	50	6.55	166	0.81	21	0.88	22	1 5/8	41	.34	9	1/8	1 21/64	34	Front	1.63	0.74	1.55	0.70
B 32197	A 17529	7/8	22	0.76	19	1.97	50	6.47	164	0.81	21	0.88	22	1 3/4	44	.34	9	1/8	1 21/64	34	Mid	1.42	0.64	1.69	0.77
A 15500		1 1/8	29	0.90	23	2.06	52	6.64	169	0.81	21	0.88	22	1 5/8	41	.34	9	1/8	1 21/64	34	Back	1.43	0.65		
A 16312	A 17516	1 1/8	29	0.90	23	2.06	52	6.64	169	0.81	21	0.88	22	1 5/8	41	.34	9	1/8	1 21/64	34	Front	1.66	0.75	1.55	0.70

Torque To Seal

Front Seat	Back Seat	Pack Gland	Pipe Plug	Plastic Cap	Brass Cap	Steel Cap					
(ft-lb)	(N-m)	(ft-lb)	(N-m)	(ft-lb)	(N-m)	(ft-lb)					
22 - 40	30 - 54	25 - 45	34 - 61	15 - 25	20 - 34	2 - 3 Threads Exposed	Hand Tight	40 - 50	54 - 68	NA	NA

References

Valve Part Number	Valve Kit *	Body Number	Standard Seal Cap			Replacement Seal Cap			Replacement Kit**	Manufacturer Reference	
			Material	Seal Cap *****	Kit	Plastic*****	Brass*****	Steel		Carrier	Copeland
A 16310		A 04707	Plastic	P 34632	P 35915	P 34632	A 15099	A 17419			
A 16311	A 17515	A 04707	Plastic	P 34632	P 35915	P 34632	A 15099	A 17419		998-0510-12	
B 32197	A 17529	A 04715	Plastic	P 34632	P 35915	P 34632	A 15099	A 17419	06DA660-062		
A 15500		A 04707	Plastic	P 34632	P 35915	P 34632	A 15099	A 17419			
A 16312	A 17516	A 04707	Plastic	P 34632	P 35915	P 34632	A 15099	A 17419		998-0510-13	

* Valve kit includes valve, gasket and bolts

** Replacement kit contains components to pack stem (pack gland, packing and pack washer)

*** Cap and cap gasket kit

**** Seal cap and o-ring kit

***** O-ring included