

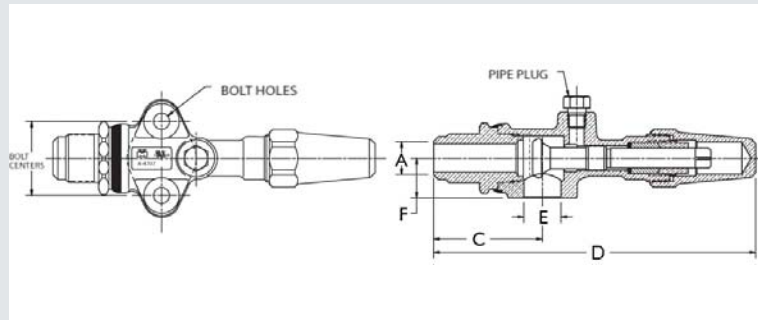

Features:

- Design Pressure (DP) / Maximum abnormal pressure (MAP): 700 psig, 48 bar
- Continuous operating temperature (COT): -40°F/300°F, -40°C/149°C
- Contact factory or visit website for compatibility with CFC, HCFC, HFC and HFO refrigerants and oils
- UL/cUL Recognized, Conforms to Pressure Equipment Directive 2014/68/EU
- 100% tested
- Asbestos-free valve packing
- Valve openings designed for maximum flow and minimum pressure drop



Valve Part Number	A		B		C		D		E		F		Bolt Centers		Bolt Hole Diameter		Pipe Plug Size	Flange Thickness		Seat Position	Valve Wt	
	in	mm	in	mm	in	mm	in	mm	in	mm	in	mm	in	mm	in	mm	in	in	mm		lb	kg
A 13166	3/4	19			2.37	60	7.05	179	0.81	21	0.85	22	1 5/8	41	.34	9	1/8	1 1/4	32	Mid	1.78	0.81

Torque To Seal

Front Seat		Back Seat		Pack Gland		Pipe Plug	Plastic Cap	Brass Cap		Steel Cap	
(ft-lb)	(N-m):	(ft-lb)	(N-m):	(ft-lb)	(N-m):			(ft-lb)	(N-m)	(ft-lb)	(N-m)
22 - 40	30 - 54	25 - 45	34 - 61	15 - 25	20 - 34	2 - 3 Threads Exposed	Hand Tight	40 - 50	54 - 68	NA	NA

References

Valve Part Number	Body Number	Standard Seal Cap				Replacement Seal Cap			Replacement Kit**	Manufacturer Reference	
		Material	Seal Cap	Gasket	O-ring Kit****	Plastic	Brass****	Steel		Carrier	Copeland
A 13166	A 04707	Brass	A 04775	A 04710	A 15099		A 15099		A 17419		

* Valve kit includes valve, gasket and bolts

** Replacement kit contains components to pack stem (pack gland, packing and pack washer)

*** Cap and cap gasket kit

**** Seal cap and o-ring kit

***** O-ring included