

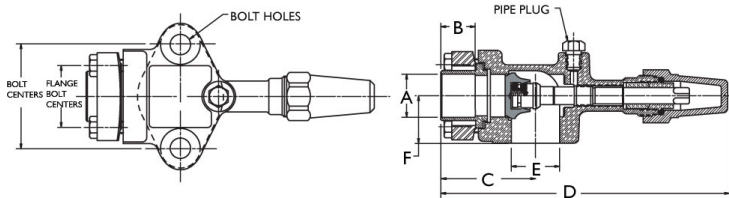

**Features:**

- Design Pressure (DP) / Maximum abnormal pressure (MAP): 700 psig, 48 bar
- Continuous operating temperature (COT): -40°F/300°F, -40°C/149°C
- Contact factory or visit website for compatibility with CFC, HCFC, HFC and HFO refrigerants and oils
- UL/cUL Recognized, Conforms to EU Pressure Equipment Directive and UK Pressure Equipment Regulation
- 100% tested
- Asbestos-free valve packing
- Valve openings designed for maximum flow and minimum pressure drop



Valve Part Number	Valve Kit Part Number	A		B		C		D		E		F		Bolt Centers		Bolt Hole Diameter		Pipe Plug Size	Flange Thickness		Seat Position	Valve Wt		Valve Kit Wt	
		in	mm	in	mm	in	mm	in	mm	in	mm	in	mm	in	mm	in	mm	in	mm	in		mm	lb	kg	lb
A 16314	A 17527	7/8	22	0.75	19	2.31	59	7.33	186	1.25	32	1.25	32	2 3/4	70	.531	13	1/8	1	25	Front	3.90		4.05	1.84
A 16315	A 17525	1 1/8	29	0.91	23	2.47	63	7.49	190	1.25	32	1.25	32	2 3/4	70	.531	13	1/8	1	25	Front	3.66		4.03	1.83
A 16316	A 17526	1 3/8	35	0.97	25	2.47	63	7.49	190	1.25	32	1.25	32	2 3/4	70	.531	13	1/8	1	25	Front	3.65		3.80	1.72

**Torque To Seal**

Front Seat		Back Seat		Pack Gland		Pipe Plug	Plastic Cap	Brass Cap	Steel Cap		
(ft-lb)	(N-m):	(ft-lb)	(N-m):	(ft-lb)	(N-m):			(ft-lb)	(N-m)	(ft-lb)	(N-m)
30 - 40	41 - 54	22 - 45	30 - 61	15 - 25	20 - 34	2 - 3 Threads Exposed	Hand Tight	40 - 50	54 - 68	NA	NA

**References**

Valve Part Number	Valve Kit Part Number *	Body Number	Standard Seal Cap		Replacement Seal Cap		Replacement Kit**	Manufacturer Reference to Valve Kit Part Number	
			Material	Seal Cap *****	Kit	Plastic *****		Brass***	Carrier
A 16314	A 17527	A 03416	Plastic	P 34632	P 35915	P 34632	A 15099	A 17419	998-0510-10
A 16315	A 17525	A 03416	Plastic	P 34632	P 35915	P 34632	A 15099	A 17419	998-0510-09
A 16316	A 17526	A 03416	Plastic	P 34632	P 35915	P 34632	A 15099	A 17419	998-0510-11

\* Valve kit includes valve, gasket and bolts

\*\* Replacement kit contains components to pack stem (pack gland, packing and pack washer)

\*\*\* Cap and cap gasket kit

\*\*\*\* Seal cap and o-ring kit

\*\*\*\*\* O-ring included