

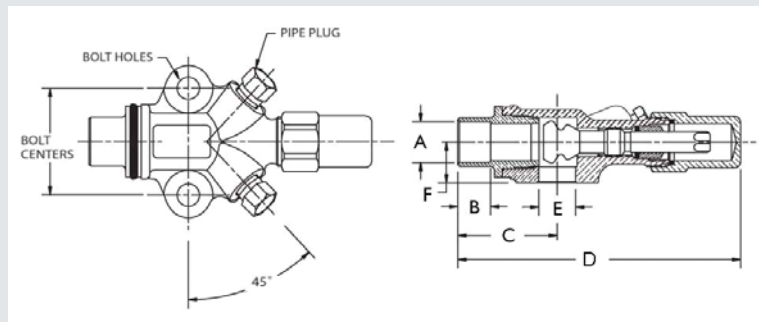

Features:

- Design Pressure (DP) / Maximum abnormal pressure (MAP): 700 psig, 48 bar
- Continuous operating temperature (COT): -40°F/300°F, -40°C/149°C
- Contact factory or visit website for compatibility with CFC, HCFC, HFC and HFO refrigerants and oils
- UL/cUL Recognized, Conforms to Pressure Equipment Directive 2014/68/EU
- 100% tested
- Asbestos-free valve packing
- Valve openings designed for maximum flow and minimum pressure drop



Valve Part	Valve Kit Part Number	A		B		C		D		E		F		Bolt Centers		Bolt Hole Diameter		Pipe Plug		Flange Thickness		Seat Position	Valve Wt		Valve Kit Wt	
		in	mm	in	mm	in	mm	in	mm	in	mm	in	mm	in	mm	in	mm	in	mm	in	mm		lb	kg	lb	kg
A 16307	A 17510	3/8	10	0.31	8	1.27	32	4.07	103	0.56	14	0.62	16	15/8	41	.34	9	1/8	7/8	22	Front	0.69	0.31	0.73	0.33	
A 16308	A 17511	1/2	13	0.38	10	1.40	36	4.20	107	0.56	14	0.62	16	15/8	41	.34	9	1/8	7/8	22	Front	0.86	0.39	0.90	0.41	
A 16309	A 17512	5/8	17	0.50	13	1.52	39	4.32	110	0.56	14	0.62	16	15/8	41	.34	9	1/8	7/8	22	Front	0.88	0.40	0.92	0.42	
A 16309	A 17531	5/8	17	0.50	13	1.52	39	4.32	110	0.56	14	0.62	16	15/8	41	.34	9	1/8	7/8	22	Front	0.88	0.40	0.93	0.42	

Torque To Seal

Front Seat		Back Seat		Pack Gland		Pipe Plug	Plastic Cap	Brass Cap		Steel Cap	
(ft-lb)	(N-m):	(ft-lb)	(N-m):	(ft-lb)	(N-m):			(ft-lb)	(N-m)	(ft-lb)	(N-m)
14 - 18	19 - 24	14 - 18	19 - 24	8 - 12	11 - 16	2 - 3 Threads Exposed	NA	20 - 30	27 - 41	3 - 5	4 - 7

References

Valve Part Number	Valve Kit Part Number *	Body Number	Standard Seal Cap		Replacement Seal Cap			Replacement Kit**	Manufacturer Cross Reference to Valve Kit Part Number	
			Material	Seal Cap	Plastic	Brass***	Steel		Carrier	Copeland
A 16307	A 17510	A 09464	Steel	A 04566	P 34627	A 16474	A 04566	A 17420	998-0510-04	
A 16308	A 17511	A 09464	Steel	A 04566	P 34627	A 16474	A 04566	A 17420	998-0510-05	
A 16309	A 17512	A 09464	Steel	A 04566	P 34627	A 16474	A 04566	A 17420	998-0510-06	
A 16309	A 17531	A 09464	Steel	A 04566	P 34627	A 16474	A 04566	A 17420		

- # Plastic Bag
- * Valve kit includes valve, gasket and bolts
- ** Replacement kit contains components to pack stem (pack gland, packing and pack washer)
- *** Cap and cap gasket kit
- **** Seal cap and o-ring kit
- ***** O-ring included